

SAFETY, HEALTH AND ENVIRONMENTAL INFORMATION		WORKS STAGE
IN ADDITION TO THE HAZARDS/RISKS NORMALLY ASSOCIATED WITH THE TYPES OF WORK DETAILED ON THIS DRAWING, NOTE THE FOLLOWING:		C = CONSTRUCTION M = MAINTENANCE D = DECOMMISSION/DEMOLITION
HEALTH & SAFETY ▲		
HS/HS/001 - WORKS IN CLOSE PROXIMITY TO PUBLIC		C / M / D
HS/HS/002 - WORKING NEXT TO LIVE TRAFFIC		C / M / D
HS/HS/003 - WORKING NEXT TO STEEP EMBANKMENTS		C / M / D
HS/HS/004 - WORKING ON / NEXT TO EXISTING BRIDGE		C / M / D
HS/HS/005 - WORKING WITHIN EXISTING RIVER		C / M / D
HS/HS/006 - WORKING NEXT TO SMALL WATERCOURSE		C / M / D
HS/HS/007 - WORKING UNDER EXISTING OVERHEAD LINES		C / M / D
ENVIRONMENTAL ▲		
HS/SE/001 - WORKS IN CLOSE PROXIMITY TO EXISTING TREE ROOT PROTECTION ZONES		C / D
HS/SE/002 - VEGETATION CLEARANCE - POTENTIAL FOR HABITAT DISTURBANCE		C / D
HS/SE/003 - VEGETATION CLEARANCE - POTENTIAL FOR PROTECTED SPECIES		C / D
UTILITIES ▲		
HS/SU/001 - EXISTING UTILITIES		C / M / D
IT IS ASSUMED THAT ALL WORKS WILL BE CARRIED OUT BY A COMPETENT CONTRACTOR WORKING, WHERE APPROPRIATE, TO AN APPROVED METHOD STATEMENT. TO BE READ IN CONJUNCTION WITH RISK REGISTER FOR FURTHER INFORMATION AND MITIGATION MEASURES.		

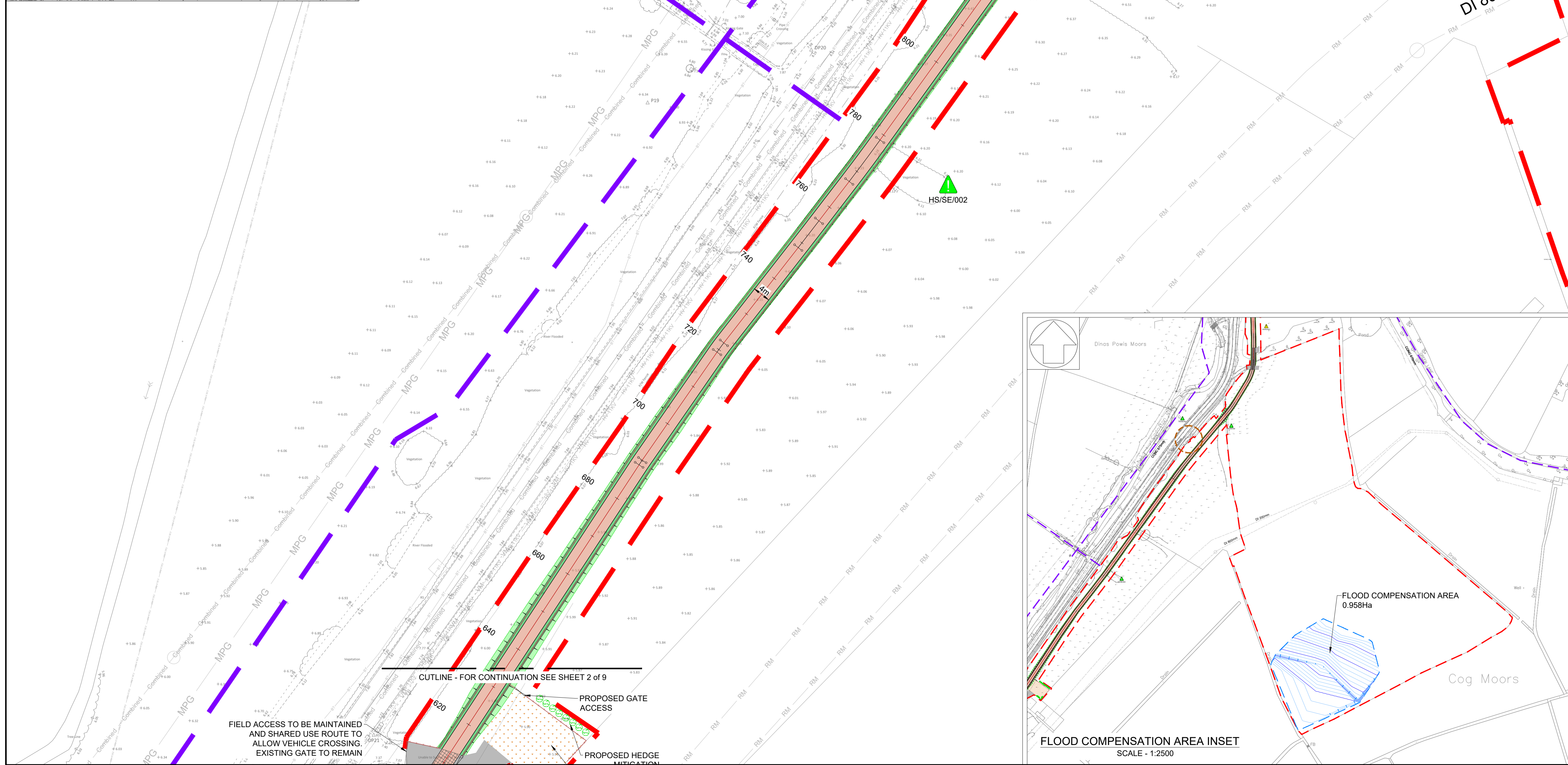

- NOTES
- DO NOT SCALE FROM DRAWING. USE FIGURED DIMENSIONS ONLY.
 - ALL UNITS ARE IN METERS UNLESS STATED OTHERWISE.
 - REFER TO DRAWING 10058585-ARC-XX-010-DR-C-00004 FOR GENERAL ARRANGEMENT OVERVIEW.
 - REFER TO DRAWING 10058585-ARC-XX-010-DR-C-00019 FOR SITE LOCATION PLAN.
 - REFER TO DRAWING 10058585-ARC-XX-010-DR-C-00039-00040 FOR EXISTING SITE PLANS.
 - REFER TO DRAWING 10058585-ARC-XX-072-DR-C-00001 FOR TYPICAL CROSS SECTIONS.
 - REFER TO DRAWINGS 10058585-ARC-XX-130-DR-C-00001-00009 FOR PROPOSED STREET LIGHTING LAYOUTS.

KEY

	PLANNING BOUNDARY
	PROPOSED SHARED FOOTWAY/CYCLEWAY
	SUITABLE HEAVY VEHICLE CROSSOVER
	PROPOSED EARTHWORKS
	PROPOSED VERGE
	EXISTING GRAVEL TRACK
	PUBLIC RIGHT OF WAY
	PROPOSED POST AND RAIL FENCE

Rev	Date	Description	Prod.	Chk.	Rev.	App.
P01	11/11/24	FIRST ISSUE	GJ	SD	MG	MG

VALE OF GLAMORGAN
BRO MORGANNWG

Project: Biglis to Dinas Powys ATR

Site: Biglis to Dinas Powys Cardiff
Client: Vale of Glamorgan Council Civic Offices, Holford Rd, Barry CF83 4RU, www.valeofglamorgan.gov.uk

ARCADIS

Registered office: 80 Fenchurch Street, London EC3M 4BY
Coordinating office: Arcadis Suite 4d, 4th Floor, Hodge House, 144-166 St Mary St, Cardiff CF10 1DY, Tel: 44 (0)29 2092 6700

www.arcadis.com © Copyright reserved

GENERAL ARRANGEMENT SHEET 3 OF 9

Designed: G.Jones	Signed: Digitally Signed	Date: 29/08/24
Produced: G.Jones	Signed: Digitally Signed	Date: 08/11/24
Checked: S.Davies	Signed: Digitally Signed	Date: 08/11/24
Reviewed: M.Griffiths	Signed: Digitally Signed	Date: 11/11/24
Approved: M.Griffiths	Signed: Digitally Signed	Date: 11/11/24
Design Stage: Preliminary Design		
Original Size: A1	Grid: OS	Datum: ODN
Suitability Code: S1	Scale: 1:500	Project Number: 10058585
Suitable for Coordination		
Drawing Number: 10058585 - ARC - XX - 010 - DR - C - 00007		Revision: P01